

## NORFOLK RURAL SCHOOLS SURVEY

Name of school	Photo reference
Welney Mission School	Welney_Mission_School_01-7.jpg

### Grid Reference

TL53709310

**Is the building listed?** no

### School Address

Tall Pines, School House

Station Road

Suspension Bridge

Welney

A much altered group of school and school house. School closed 1927

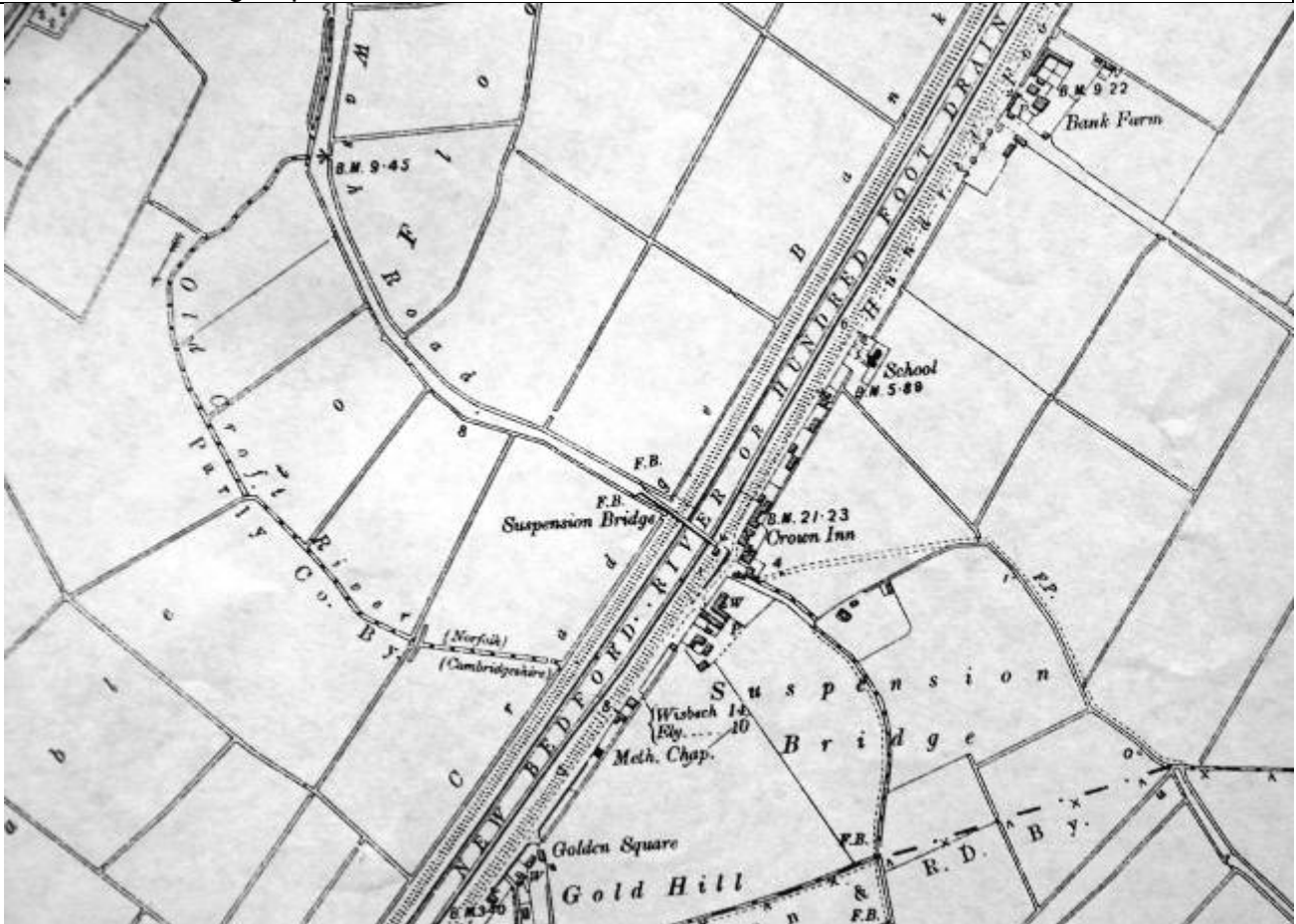

## NORFOLK RURAL SCHOOLS SURVEY

Photograph 1	Photograph 2
 <p data-bbox="153 705 405 741">southwest aspect</p>	 <p data-bbox="813 705 1066 741">northwest aspect</p>

Photograph 3	Google Maps 2009
 <p data-bbox="153 1321 421 1357">west aspect, detail</p>	 <p data-bbox="813 1523 1082 1559">school at top right</p>

### Document references

Building plans in NRO	x
Building plans in other	X
Sale particulars in NRO	X
Sale particulars in	X

## NORFOLK RURAL SCHOOLS SURVEY

other	
Log books in NRO	X
Log books in school	X
Photographs in NRO Other sources in NRO	X Acc 2009/304 (1903 survey)p.472
Photographs in other	

<p><b>Directory entry (1920s or nearest date)</b></p>	<p><b>Kelly 1883</b> The Hundred-foot Bank Church of England school, commonly called the Mission school, was built in 1874; at this school the children likewise receive a free education: both these schools were built by Marshall's charity: the Mission school is also licensed for divine service; the services are morning and afternoon on Sunday, and evening on Friday; Charles Thompson, master.</p> <p><b>White 1883 p.783</b> The 100 Foot Bank Church of England School commonly called the Mission School was built in 1874. At this school the children of the poor likewise receive a free education and is attended by 73 children. Both these schools were built by Marshall's Charity. The Mission School is also licensed for Divine Service.</p> <p><b>Kelly 1896</b> Church of England Free, Hundred-foot Bank, built in 1874, also from Marshall's Charity, for 80 children; average attendance, 52; George Crowden Fleming, master: this school, known as the "Mission school," is also licensed for divine service, which is held on Sundays in the afternoon &amp; evening. Mission school licensed for worship.</p> <p><b>Kelly 1908 p.521</b> Public Elementary (Free), Hundred-foot Bank, built in 1874, also from Marshall's Charity, for 80 children; average attendance, 54; Mrs Bessie Thomas, mistress. This school, known as the "Mission school," is also licensed for divine service, which is held here on Sundays in the evening.</p> <p><b>Kelly 1916 p.525</b> Church of England (Free), Hundred-foot Bank, built in 1874, also from Marshall's Charity, for 80 children; Mrs Bessie Mayes, mistress. This school, known as the "Mission school," is also licensed for divine service, which is held here on Sundays in the evening.</p> <p><b>Kelly 1921</b> Church of England Free School 100 Foot Bank, built 1874 also from Marshall's Charity, for 80 children, no longer used as a school. This school, known as the Mission School, is also licensed for divine service which is held here on</p>
---	---

## NORFOLK RURAL SCHOOLS SURVEY

	Sunday in the evening.
<b>Date of construction</b>	<b>1874</b>
<b>Architects (if known)</b>	X
<b>Position within parish</b>	East of the washes, remote from Welney and other settlements, in a small group of houses and a chapel.
<b>Catchment area in 1940s</b>	Closed in 1927, children taught first in Welney and later at Ten Mile Bank, Hilgay.

### Plan – describe or include scan

NRO Acc 2009/304 (1903 survey)p.472

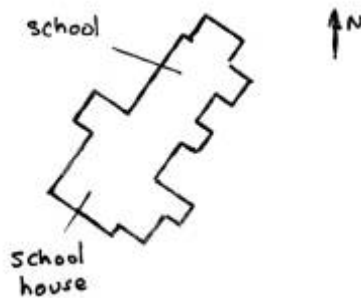
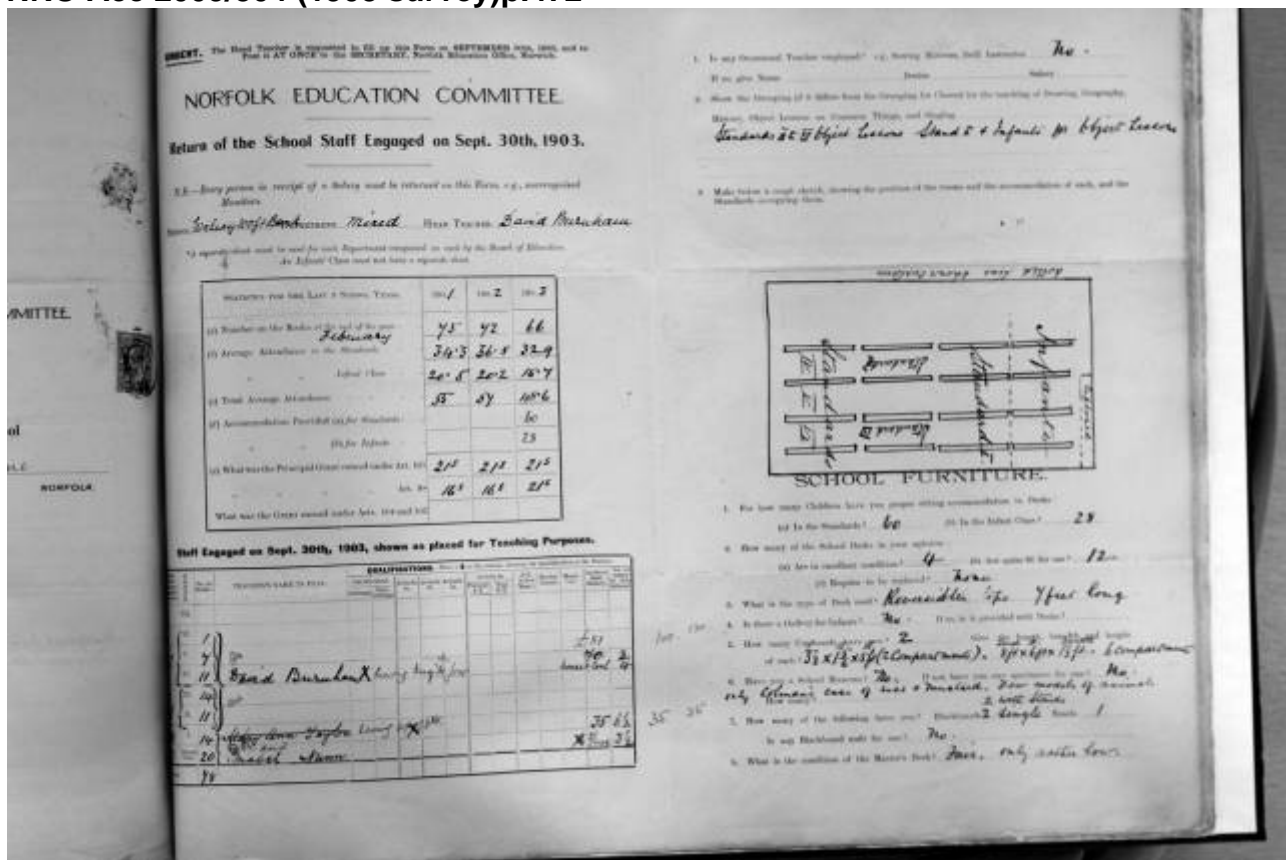

Two storey school house to the south, single storey single room school to the north. Infants initially curtained off from other classes. Due to the remoteness of the site, the school was licensed for worship. The 1903 survey

## NORFOLK RURAL SCHOOLS SURVEY

notes that the desks had reversible tops which could indicate they were similar to the reversible desks at Holbeach Drove St Polycarp, Lincolnshire, in order to facilitate worship.

Note: the school and school house were sold for private occupation in 1927. There was a fire in 2007. It is assumed that much of the fabric has been replaced.



Reversible desks, at Holbeach Drove St Polycarp, Lincolnshire tops in worship position.  
Note holes for inkwells.

<b>How many storeys</b>	One
<b>How many rooms</b>	One
<b>Present use</b>	Private house
<b>Name of present owner</b>	x
<b>Condition (1 =derelict – 5 = good)</b>	x
<b>Is there a teacher's house associated with school? Give some idea of date, size and style</b>	Yes, substantial two-storey building, 1874.

### Building Features

<i>Windows: number, position, size, no of lights, style (sash, leaded, etc)</i>	Not original.
<i>Chimneys: number, style</i>	None remain on school, single chimney with

## NORFOLK RURAL SCHOOLS SURVEY

	five flues on school house.
<i>Ventilators: number, position</i>	X
<i>Doors: number, position, inscription over (Boys – Girls) style</i>	x
<i>Porches: number, position, inscription etc</i>	One at southwest corner of school.
<i>Bell towers/clock and other ornamentation</i>	x

### Overall style

<i>Gothic/ecclesiastical (pointed windows and doors)</i>	X
<i>Classical/Georgian (triangular pediments, sash windows)</i>	X
<i>Tudor/flat headed windows with drip moulding, ornate chimneys</i>	x
<i>Plain and functional with no ornamentation</i>	Relatively plain.
<i>Inscriptions, coats of arms etc</i>	x

### Building materials

Roof-note decorative features (coloured and fancy tiles)	Decorative ridge tiles on school house.
Walls-note decorative work (flint work, diaper bricks etc)	Wisbech brown brick with red brick string courses in pairs. Dentillated eaves on school house gable.

**For architectural terminology, see the glossary in Pevsner**

### Internal (room by room) materials and features such as:

<i>Panelled walls</i>	X
<i>Fire places/heating appliances</i>	X
<i>Plaster/modern ceilings, open to roof</i>	X
<i>Original cupboards</i>	x
<i>Room divisions/folding doors</i>	X
<i>Permanent art work</i>	x

### Building sequence

Single build. (1897)
----------------------

## NORFOLK RURAL SCHOOLS SURVEY

### Playground

<i>Boundary Marked by railings, stone wall or other including gates leading into</i>	x
<i>Size (approx)</i>	X
<i>Type (tarmac enclosure, field – nature garden, climbing frames, games painted on ground</i>	X
<i>Buildings – out houses, mobiles, 'offices'</i>	x

**Include here any additional material (scans of sketch plans, old photographs, oral evidence, etc, précis of school history**

[www.british-history.ac.uk/report.aspx?compid=21919](http://www.british-history.ac.uk/report.aspx?compid=21919)

Another school, which served also as a mission room, was opened in 1874. It stood near the suspension bridge, and was intended for the children living on the far side of the Bedford Rivers. ([fn. 90](#)) It was closed in 1927, when its 43 pupils were transferred to Marshall's School in the village. This arrangement proved unsatisfactory owing to the almost annual flooding of the Washes between the Bedford Rivers, and shortly before 1938 the children were again transferred, but this time to Hilgay (Norf.).

[www.welney.org.uk/schools/susp-bridge-school/mission-sch.htm](http://www.welney.org.uk/schools/susp-bridge-school/mission-sch.htm)

<b>Date of survey</b>	April 2010
<b>Name(s) of surveyor(s)</b>	A.R. Forrest